

Technical specification



Model name		LS10-B		
Model number		LS10-B60*S (LS10-B60*C)	LS10-B70*S (LS10-B70*C)	LS10-B80*S (LS10-B80*C)
Arm length (J1+J2)		600	700	800
Payload*1	Rated (kg)	5		
	Max. (kg)	10		
Repeatability	(J1+J2) (mm)	+/- 0.02	+/- 0.02	+/- 0.025
	(J3) mm	+/- 0.01		
	(J4) deg	+/- 0.01		
Standard cycle time (s)*2		Less than 0.389	Less than 0.409	Less than 0.449
Max. operation speed	(J1+J2) mm/s	9100	9800	10500
	(J3) mm/s	1100		
	(J4) deg/s	2500		
Join#4 allowable moment of inertia*3	Rated (kg m ²)	0.02		
	Max. (kg m ²)	0.3		
(J3) down force (N)		200		
Mounting type		Floor		
Installation Environment		Standard or Clean (ISO4, Not ESD applied)		
Weight (kg) (cables not included)		22	22	23
Applicable Controller		RC90-B		
Cable length (m)*4		3, 5, 10		
Installed wire for customer use		D-sub 15 pin x1, RJ45 8 pin (CAT 5e) x1		
Installed pneumatic tube for customer use		Ø6mm x2, Ø4mm x1		
Power	(V)	AC200-240		
Power Consumption*4	(kVA)	1.8		
Cable length (m)*5		3, 5, 10		
Safety standard		EU Directive Complied *5, KC, KCs ANSI/RIA R15.06-2012, NFPA 79 (2007 Edition)		

J1 = Axis 1 J3 = Axis 3

J2 = Axis 2 J4 = Axis 4

*1 : Do not apply the load exceeding the maximum payload.

*2 : Cycle time based on round-trip arch motion (300mm horizontal, 25mm vertical) with Accel 120% and 2kg payload (path coordinates optimised for maximum speed).

*3 : If the centre of gravity is at the centre of each arm. If the centre of gravity is not at the centre of each arm, set the eccentric quantity using INERTIA command.

SEG Internal Info:

*4 : It depends on operating environment and operation program.

*5 : Standard cable only. There is no setting of the flexible cable. If necessary, a new MT or product planning is necessary.

Top view

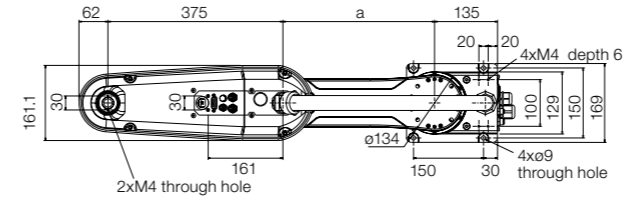

Working range, LS10-B602S

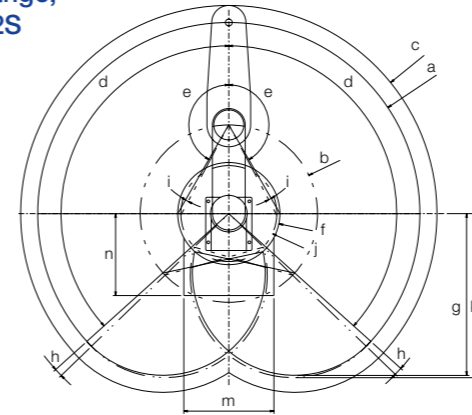

Working range, Epson SCARA LS10-B

		LS10-B60**	LS10-B70**	LS10-B80**
a	Arm #1 + Arm #2 length (mm)	600	700	800
b	Arm #1 length (mm)	225	325	425
c	Arm #2 length (mm)		275	
d	(J1) motion angle (deg)		132	
e	(J2) motion angle (deg)		150	
f	Motion range (deg)	138.1	162.6	232
g	Motion range at the rear (deg)	425.6	492.5	559.4
h	Angle of the (J1) mechanical stop (deg)		2.8	
i	Angle of the (J2) mechanical stop (deg)		4.2	
j	Mechanical stop area (mm)	121.8	142.5	214
k	Mechanical stop area at the rear (mm)	433.5	504	574.5
m	(J3) motion range (mm)	LS10-B**2S	200	
		LS10-B**3S	300	
n	Distance from the base mounting face (mm)	LS10-B**2*	53	
		LS10-B**3*	153	
p	(J3) mechanical stop area upper end (mm)	LS10-B***S	4	
q	(J3) mechanical stop area lower end (mm)		3	

A = Centre of Joint #3
B = Motion range

C = Maximum range
D = Base mounting face

E = Area limited by a mechanical stop

Side view

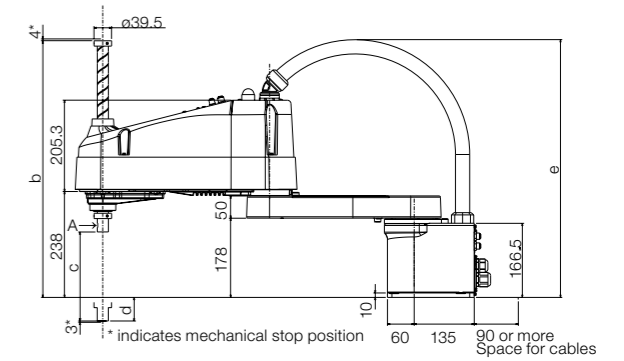

Rear view

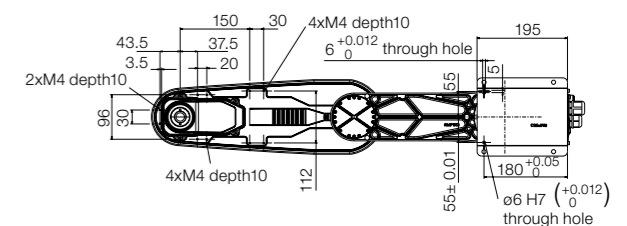

Flange (standard)

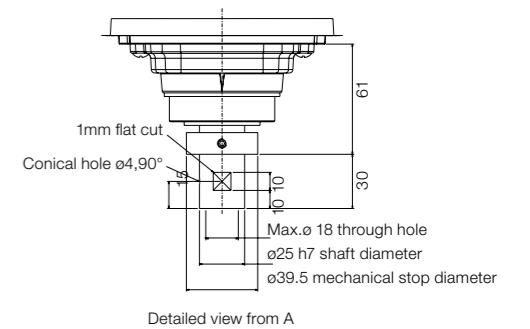

Flange (cleanroom)

